

Department of Public Works

Bureau of Engineering  
Report No. 3

November 6, 2024  
CD No. 15

**REQUEST FOR AUTHORITY FOR A FULL CLOSURE OF 220<sup>TH</sup> STREET FROM WESTERN AVENUE TO HARVARD BOULEVARD FOR 29 CONSECUTIVE WEEKS WITHIN A WINDOW STARTING NOVEMBER 12, 2024, AND ENDING JUNE 3, 2025, FOR THE METROPOLITAN WATER DISTRICT OF SOUTHERN CALIFORNIA SECOND LOWER FEEDER PRESTRESSED CONCRETE CYLINDER PIPE REHABILITATION REACH 3B PROJECT (WORK ORDER NO. UPERTER2, U-PERMIT NO. U-2486-0210)**

**RECOMMENDING THE BOARD OF PUBLIC WORKS:**

1. APPROVE the request for a full closure of 220<sup>th</sup> Street from Western Avenue to Harvard Boulevard for a total of 29 consecutive weeks within a window starting as early as November 12, 2024, and ending June 3, 2025.
2. AUTHORIZE the City Engineer and the Director of the Bureau of Street Services (StreetsLA) to administratively approve an additional two weeks of full closure if unforeseen conditions delay the start and or completion of this construction.

**TRANSMITTALS**

1. Copy of the email from the Office of Council District No. 15, dated September 26, 2024, supporting a temporary full closure of 220<sup>th</sup> Street between Western Avenue and Harvard Boulevard.
2. Los Angeles Department of Transportation (LADOT)-approved temporary Worksite Traffic Control Plans (WTCP) for the full closure of 220<sup>th</sup> Street.
3. Copy of the email from StreetsLA, dated October 2, 2024, providing no exceptions to the project.
4. Draft English and Spanish public notices for distribution in advance of the 220<sup>th</sup> Street Closure.

**DISCUSSION**

***Background***

The Metropolitan Water District of Southern California (MWD)'s Second Lower Feeder Prestressed Concrete Cylinder Pipe (PCCP) Rehabilitation Reach 3B Project (Project) will increase water supply reliability and reduce the risk of unplanned outages and pipeline failures by rehabilitating approximately 19,000 feet of 78-inch diameter PCCP pipeline and rehabilitating appurtenances. The project extends from 220<sup>th</sup> Street, approximately 250 feet east of Western Avenue, west toward Western Avenue, and along Western

Avenue from 219<sup>th</sup> Street to 262<sup>nd</sup> Street, and along 262<sup>nd</sup> Street in the City of Lomita, between Western Avenue and Oak Street. Rehabilitation work includes slip-lining the existing PCCP with new steel pipe and replacing isolation and sectionalizing valves, one of which is a 48-inch diameter lubricated plug valve in 220<sup>th</sup> Street, in an existing 17-foot wide by 57-foot long by 25-foot-deep vault.

The MWD has been constructing this Project in multiple phases. Previous construction has been completed in the City of Lomita and State of California Department of Transportation (Caltrans) right of way. MWD's overall Project construction began in November 2023 and is currently approximately 70 percent complete. The remaining work includes rehabilitation work along 220<sup>th</sup> Street, to be constructed under a City of Los Angeles Bureau of Engineering U-Permit and work along Western Avenue (Caltrans right-of-way) under a Caltrans Encroachment Permit.

Upon completion of construction along 220<sup>th</sup> Street, the Project will be completed with restoration of the street to vehicular traffic.



Figure No. 1 – Proposed 220<sup>th</sup> Street closure and detour plan.

Closure of 220<sup>th</sup> Street is necessary to performing the pipeline and appurtenances rehabilitation work as shown on Figure No. 1. From within the existing 220<sup>th</sup> Street valve vault, the portion of Project pipeline within 220<sup>th</sup> will be slip-lined by removing the vault roof, removing the existing valve and pipe spools, and introducing new steel liners into the existing pipe. This will be followed by installation of a new valve and appurtenances, closure of the vault, and restoration of the street. The width of the existing valve vault (17 feet) within a relative narrow street (30 feet from curb to curb) leaves scarcely 13 feet of workspace alongside the vault. This area will be utilized for contractor's staging of equipment and materials, including flatbed trucks carrying the new liner pipe segments and materials. A 500-ton crane with 20-foot-wide outriggers will be stationed on one end of the valve

vault. The closure of 220<sup>th</sup> Street will impact seven driveways and will last from November 12, 2024, through June 3, 2025. The MWD conducted extensive community outreach and mitigation, and the residents support the project.

The Office of Council District No. 15 has concurred with the proposed full street closure (Transmittal No. 1). The temporary WTCP for the street closure have been approved by the LADOT (Transmittal No. 2). StreetsLA provided no exceptions to the requested closure (Transmittal No. 3). Contract work may take place during peak hours, within the proposed closure limits.

The MWD previously communicated the closure to affected properties in person and through a community meeting on October 10, 2024, and plans to distribute notices to the public before the end of October (Transmittal No. 4). The public will be provided a call-in number and email address for any inquiries or questions regarding the construction. The MWD will respond to communications from the public, affected business, the offices of elected officials, and other impacted entities throughout the closure period.

( DW GSM BM )

Report reviewed by:

BOE (ADM)

Report prepared by:

Central District Office

Dale Williams, PE  
Acting District Engineer  
Phone No. (213) 847-0342

DW/NK/10-2024-0140\_CEN.gva

Questions regarding this report  
may be referred to:  
Naushin Kamal, PE  
Assistant District Engineer  
Phone No. (213) 847-0342  
Email: [naushin.kamal@lacity.org](mailto:naushin.kamal@lacity.org)

Respectfully submitted,

  
ENGINEERING  
Electronically Signed by Ted  
2024 12:41 PM

Ted Allen, PE  
City Engineer

**Ovalle,Cristian A**

---

**From:** Aksel Palacios <aksel.palacios@lacity.org>  
**Sent:** Thursday, September 26, 2024 10:51 AM  
**To:** Ovalle,Cristian A; Nicholas Chavez  
**Cc:** Naushin Kamal; Martinez,Lizeth; Felix,Alejandro; Chinh Dinh; Hussein, Ahmed; Aldrete Jr.,Jose D; Nazila Cruz; Coburn,Shalia K; Amy Shum; Armen Sarkisian; Stanton, Andrew M.; Campbell,Tom  
**Subject:** Re: board report

Hello Naushin,

Thank you very much for your assistance with this process, CD 15 is in concurrence with the closure for this phase of the Second Lower Feeder PCCP Rehab Reach 3 B project. We are also requesting that this item be placed before the BPW as soon as possible to ensure that the project remains on schedule and that water service and quality remain consistent in the City and surrounding South Bay Communities. Please let me know if you need any additional assistance on my end.

best,

Aksel

**Aksel Palacios**

**Director, Port & Capital Projects**

Office of Councilmember Tim McOsker

15th Council District | City of Los Angeles

Direct Line: 310.473.7015 |

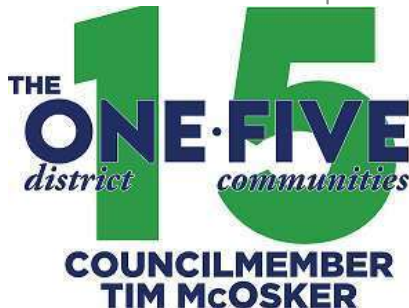

On Thu, Sep 26, 2024 at 10:03 AM Ovalle,Cristian A <[covalle@mwdh2o.com](mailto:covalle@mwdh2o.com)> wrote:

Hi All,

First, thank you Naushin for getting us the copy of the 2019 Board report. Also, thank you to all who were able to join us this morning (Chinh, Nazila, Naushin, Alex, Lizeth, Ahmed, Shalia, and Jose). Attached please find a copy of the presentation I shared with you this morning.

As we discussed, we will work collaboratively with LA BOE staff to prepare the Board report and expedite a Board action. We understand there are no guarantees, but we will remain optimistic and do everything we can in our efforts to meet our project's November 15, 2024 start date for construction activities in 220<sup>th</sup> Street.



Please contact me if you have any questions about this email.

Best,

**Cristian Ovalle, PE**

Team Manager, Pipeline Rehab PM Team

Metropolitan Water District of Southern California

700 North Alameda Street, Los Angeles CA 90012

(213) 217-5684 mobile: (310) 880-0454

---

**From:** Naushin Kamal <[naushin.kamal@lacity.org](mailto:naushin.kamal@lacity.org)>

**Sent:** Thursday, September 26, 2024 9:50 AM

**To:** Martinez,Lizeth <[LMartinez@mwdh2o.com](mailto:LMartinez@mwdh2o.com)>

**Cc:** Felix,Alejandro <[AFelix@mwdh2o.com](mailto:AFelix@mwdh2o.com)>; Aksel Palacios <[aksel.palacios@lacity.org](mailto:aksel.palacios@lacity.org)>; Amy Shum <[amy.shum@lacity.org](mailto:amy.shum@lacity.org)>; Armen Sarkisian <[armen.sarkisian@lacity.org](mailto:armen.sarkisian@lacity.org)>; Chinh Dinh <[chinh.dinh@lacity.org](mailto:chinh.dinh@lacity.org)>; Ovalle,Cristian A <[covalle@mwdh2o.com](mailto:covalle@mwdh2o.com)>; Hussein, Ahmed <[Husseina@bv.com](mailto:Husseina@bv.com)>; Aldrete Jr.,Jose D <[jaldretejr@mwdh2o.com](mailto:jaldretejr@mwdh2o.com)>; Nazila Cruz <[nazila.cruz@lacity.org](mailto:nazila.cruz@lacity.org)>; Coburn,Shalia K <[SCoburn@mwdh2o.com](mailto:SCoburn@mwdh2o.com)>; Stanton, Andrew M. <[StantonAM@bv.com](mailto:StantonAM@bv.com)>

**Subject:** board report

Here is the board report we will emulate, if MWD can start on the draft we'll elevate it as soon as we have all the email concurrence for the rush board report through the council office.

I'll send you the updated template shortly, please provide the name contact and email of the manager i'll be working with. I didn't write it down at our meeting.

--

Naushin Kamal, P.E.

Central District | Sr. Civil Engineer

Bureau of Engineering | Department of Public Works

201 N. Figueroa St, 3rd Floor

Los Angeles, CA 90015

Mail Stop 503

Phone: [213 847-0342](tel:2138470342)

[Naushin.Kamal@lacity.org](mailto:Naushin.Kamal@lacity.org)

## ENGINEERING



---

This communication, together with any attachments or embedded links, is for the sole use of the intended recipient(s) and may contain information that is confidential or legally protected. If you are not the intended recipient, you are hereby notified that any review, disclosure, copying, dissemination, distribution or use of this communication is strictly prohibited. If you have received this communication in error, please notify the sender immediately by return e-mail message and delete the original and all copies of the communication, along with any attachments or embedded links, from your system.











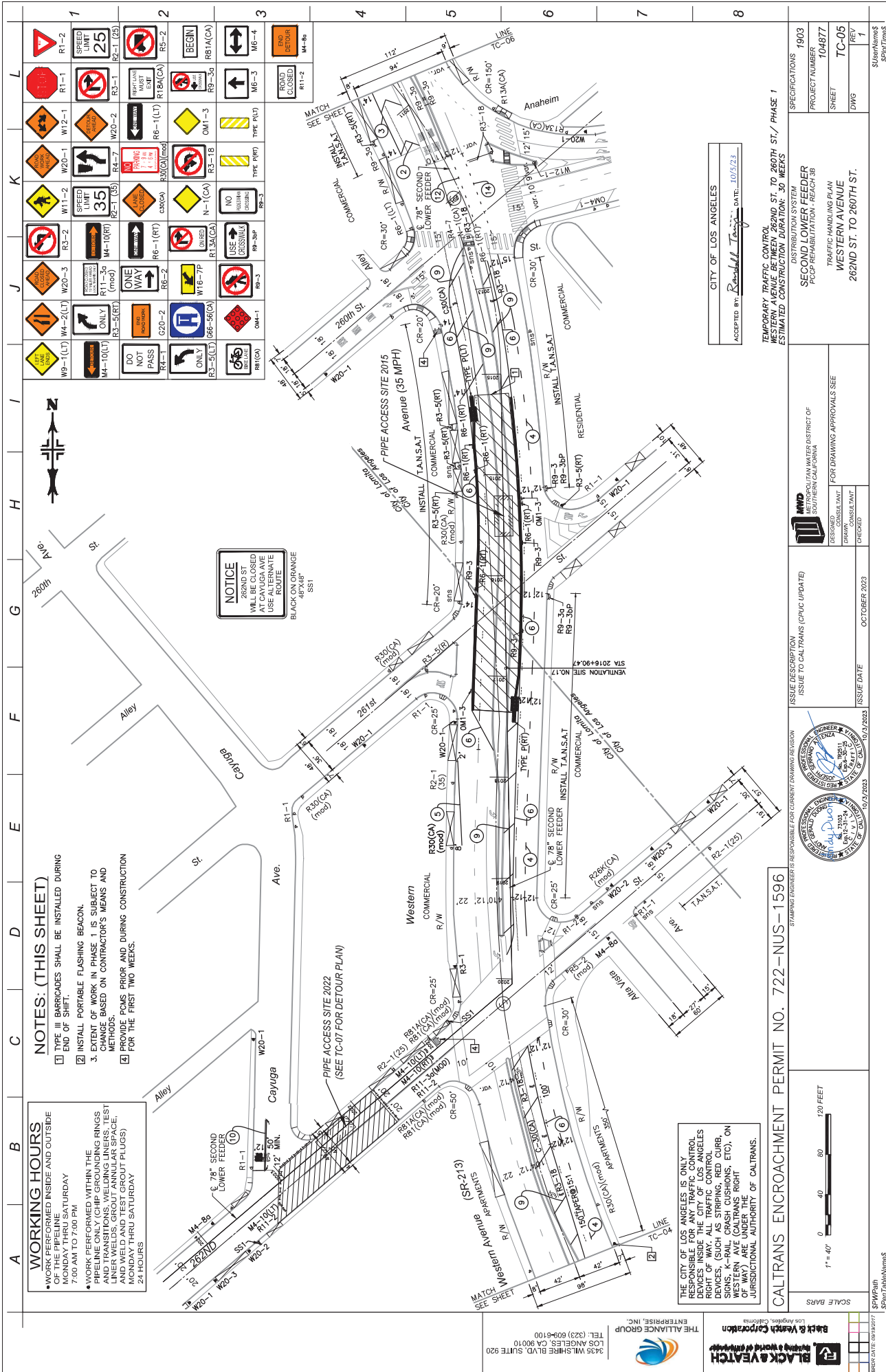

**WORKING HOURS**

- WORK PERFORMED INSIDE AND OUTSIDE OF THE PIPELINE MONDAY THRU SATURDAY 7:00 AM TO 7:00 PM
- WORK PERFORMED WITHIN THE PIPELINE ONLY (CHIP GROUNDING RINGS, LINE WELDS, GROUT ANNUAL SPACE, AND WELD AND TEST GROUT PLUGS) MONDAY THRU SATURDAY 24 HOURS

**NOTES: (THIS SHEET)**

1. TYPE III BARRICADES SHALL BE INSTALLED DURING END OF SHIFT.
2. INSTALL PORTABLE FLASHING BEACON.
3. EXTENT OF WORK IN PHASE 1 IS SUBJECT TO CHANGE BASED ON CONTRACTOR'S MEANS AND METHODS.
4. PROVIDE POMS PRIOR AND DURING CONSTRUCTION FOR THE FIRST TWO WEEKS.

**NOTICE**  
262ND ST  
WILL BE CLOSED  
AT CAYUGA AVE  
USE OF ALTERNATE  
ROUTE  
BLACK COLOR RANGE  
88'x48'  
SS1

THE CITY OF LOS ANGELES IS ONLY RESPONSIBLE FOR ANY TRAFFIC CONTROL MEASURES MADE BY THE CITY OF LOS ANGELES RIGHT OF WAY ALL TRAFFIC CONTROL DEVICES, (SUCH AS STRIPING, RED CURB, SIGNS, K-RAIL CRASH CUSHIONS, ETC), ON WESTERN AVE (CALTRANS RIGHT OF WAY) ARE UNDER THE JURISDICTIONAL AUTHORITY OF CALTRANS.

**BLACK & VEATCH**  
A WORLD OF OPPORTUNITY  
Los Angeles, California

**THE ALLIANCE GROUP**  
ENTERPRISE, INC.  
Los Angeles, California

3435 WILSHIRE BLVD, SUITE 920  
LOS ANGELES, CA 90010  
TEL: (323) 609-6100

CALTRANS ENCROACHMENT PERMIT NO. 722-NUS-1596



**STAMPING ENGINEER IS RESPONSIBLE FOR CURRENT DRAWING REVISION**

10/2/2023

10/2/2023

10/2/2023

**ISSUE DESCRIPTION**  
ISSUE TO CALTRANS (CPUC UPDATE)

**DESIGNED BY**  
CONSULTANT

**DRAWN BY**  
CONSULTANT

**CHECKED BY**  
CONSULTANT

**ISSUE DATE**  
OCTOBER 2023

**MD**  
METRO DISTRICT OF  
SOUTHERN CALIFORNIA

**FOR DRAWING APPROVALS SEE**  
WESTERN AVENUE  
262ND ST. TO 260TH ST.

1903	SPECIFICATIONS
104877	PROJECT NUMBER
TC-05	SHEET
1	DWG
1	SPOT/THOUS

CITY OF LOS ANGELES  
ACCEPTED BY: *Russell Tenny* DATE: 10/2/23

TEMPORARY TRAFFIC CONTROL  
WESTERN AVENUE BETWEEN 262ND ST. TO 260TH ST./ PHASE 1  
ESTIMATED CONSTRUCTION DURATION: 30 WEEKS



















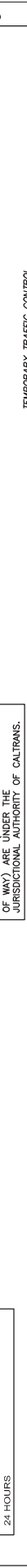

8			STAMPING ENGINEER IS RESPONSIBLE FOR CURRENT DRAWING REVISION			
					<b>ISSUE DESCRIPTION</b> ISSUE TO CAL TRANS (CPUC UPDATE)	<b>DISTRIBUTION SYSTEM</b> <b>SECOND LOWER FEEDER</b>
						<b>1903</b> <b>SPECIFICATIONS</b>

SCALE			FOR DUMPING APPROVALS SEE CONSULTANT DRAWING NO. 22611 CONSULTANT	WESTERN AVENUE 227TH ST. TO 222ND ST. TC-13 DWG JREV
-------	--	--	--	--

\$Port TableNames\$	
\$PlotTime\$	









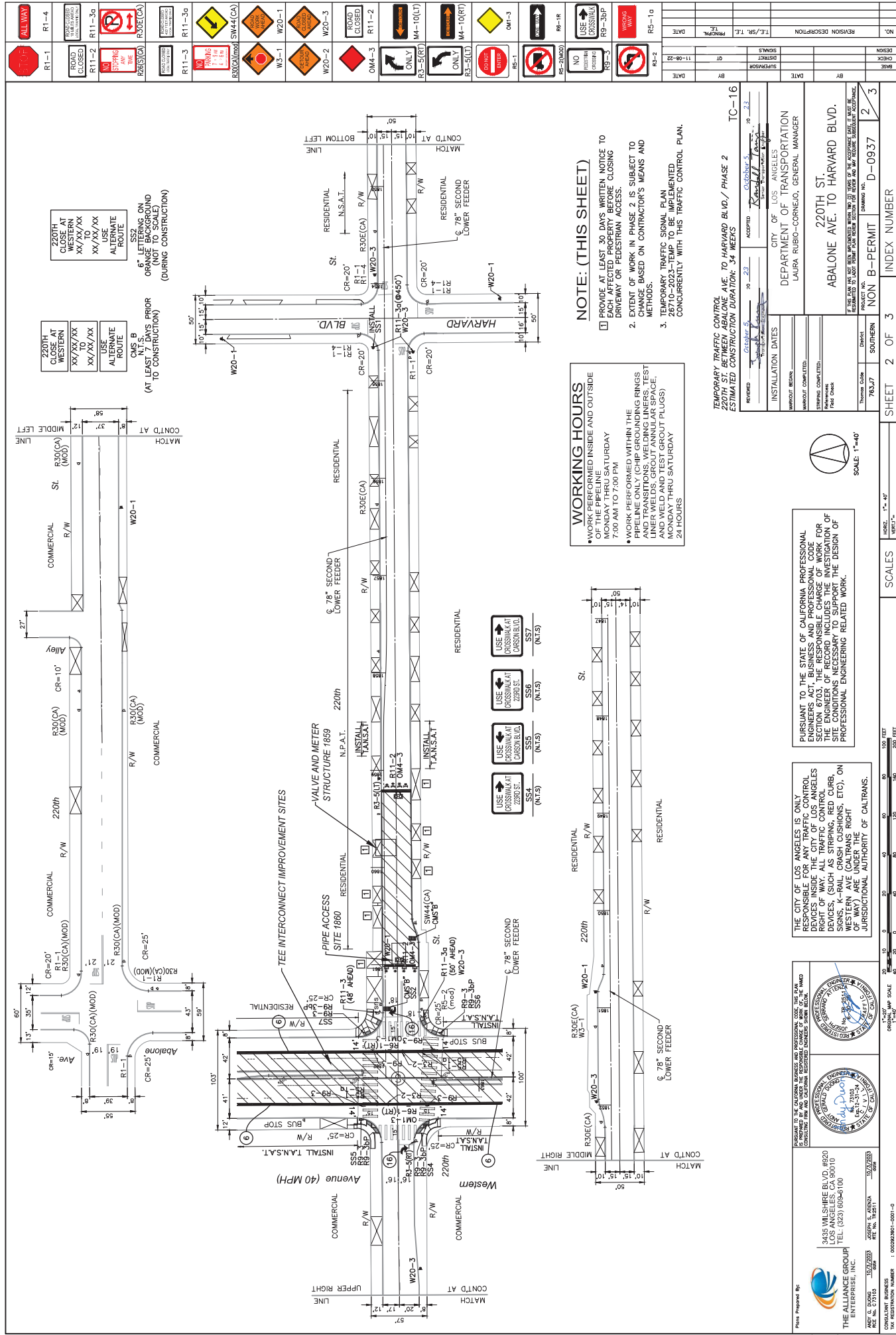





















**Ovalle,Cristian A**

---

**From:** Manuel Perez <manuel.perez@lacity.org>  
**Sent:** Wednesday, October 2, 2024 8:12 AM  
**To:** Ovalle,Cristian A  
**Cc:** Armenia Aguilar; Naushin Kamal; Aldrete Jr.,Jose D  
**Subject:** Re: MWD Second Lower Feeder PCCP Rehab Reach 3B Project - Temp Closure of 220th Street

Cristian,

You will not be required to obtain a permit from Street Services. Please work with BOE for any permit(s) you may need from them. If a full street closure is needed to perform and complete your work, we do not object.

Thank you,

Manuel Perez

On Tue, Oct 1, 2024 at 2:31 PM Ovalle,Cristian A <[covalle@mwdh2o.com](mailto:covalle@mwdh2o.com)> wrote:

Hi Manuel,

Regarding your 1:42 PM email, I believe we have support from BOE, but I'll let **Naushin** speak to that. Regarding City Council approval, we have support from the office of Council District 15 (see attached email from Aksel Palacios dated Thu 9/26/2024 10:51 AM).

Our primary objective is to obtain approval to temporarily close 220<sup>th</sup> Street for the purpose of rehabilitating a potable water pipeline, so it sounds like that falls under the utility work exemption.

Best,

**Cristian Ovalle, PE**

Team Manager, Pipeline Rehab PM Team

Metropolitan Water District of Southern California

700 North Alameda Street, Los Angeles CA 90012

(213) 217-5684 mobile: (310) 880-0454

---

**From:** Manuel Perez <[manuel.perez@lacity.org](mailto:manuel.perez@lacity.org)>  
**Sent:** Tuesday, October 1, 2024 2:12 PM  
**To:** Armenia Aguilar <[armenia.aguilar@lacity.org](mailto:armenia.aguilar@lacity.org)>  
**Cc:** Ovalle,Cristian A <[covalle@mwdh2o.com](mailto:covalle@mwdh2o.com)>; Naushin Kamal <[naushin.kamal@lacity.org](mailto:naushin.kamal@lacity.org)>; Aldrete Jr.,Jose D <[jaldretejr@mwdh2o.com](mailto:jaldretejr@mwdh2o.com)>  
**Subject:** Re: MWD Second Lower Feeder PCCP Rehab Reach 3B Project - Temp Closure of 220th Street

To ALL,

A BSS Building Permit is not required for general street work, sewer line work, utility work, etc. Our permits are only required if the work benefits a specific property address, such as the placement of an air conditioning unit on a roof would require a crane permit. A trash bin and office trailer for the construction of an apartment complex.

Here is the link to apply for a permit - <https://bsspermits.lacity.org/buildingmaterials/index1.cfm>

Contact me directly if you need further clarification.

Thank you,

Manuel Perez

On Tue, Oct 1, 2024 at 1:57 PM Armenia Aguilar <[armenia.aguilar@lacity.org](mailto:armenia.aguilar@lacity.org)> wrote:

Hi Manuel,

Sounds like the request is for a street use permit to temporarily close while in construction. Are those available to apply for online?

Armenia H. Aguilar  
Permit Case Management Division | Civil Engineer Associate II

Bureau of Engineering | Department of Public Works  
201 N. Figueroa St., Suite 290

Los Angeles, CA 90012

Mail Stop 901

O: (213) 808-8575

[armenia.aguilar@lacity.org](mailto:armenia.aguilar@lacity.org)



The Bureau of Engineering (BOE) has a new online Customer Service Request (CSR) application to receive all inquiries and requests that do not already have an avenue for submission in other BOE web applications. These include requests for clearances related to City Planning or LADBS building permits.

The CSR application, and all other BOE applications, are accessible through our online portal, which can be found at <http://engpermits.lacity.org/>.

The normal response time for CSR requests is one to three days, with a maximum of about a week during unusual periods. Requests are taken in the order received and are monitored closely to ensure that all are responded to. You will be notified by email when there is a response and can log in any time to check the status. In order to serve you better, requests and questions are no longer accepted via phone or email.

On Tue, Oct 1, 2024 at 1:42 PM Manuel Perez <[manuel.perez@lacity.org](mailto:manuel.perez@lacity.org)> wrote:

Cristian,

This request should come directly from the Bureau of Engineering in the form of an Official City Interdepartmental Correspondence Letter, which we usually receive from Armenia Aguilar who is included in this email. Before we make a comment or objection, we need to know if BOE supports this closure. It may also require approval from the City Council.

Regards,

Manuel Perez

On Tue, Oct 1, 2024 at 1:21 PM Ovalle,Cristian A <[covalle@mwdh2o.com](mailto:covalle@mwdh2o.com)> wrote:

Hi Manuel,

My name is Cristian Ovalle, and I am manager of the Pipeline Rehabilitation Project Management Team at Metropolitan Water District. I am working with Naushin in getting Board of Public Works approval to temporarily close 220<sup>th</sup> Street, from November 15, 2024, through April 25, 2025, for construction of the Second Lower Feeder PCCP Rehab Reach 3B Project. Naushin advised me to talk with you as we should have a statement from the Bureau of Street Services that they have no objections to the proposed street closure. Would you please let me know if you are the right person I should be talking with to get such a statement from BSS, and what information you need, or refer me to someone who can help? I apologize for the short notice, but this need for input from BSS is something we just became aware of so we are hoping to expedite this process.

**Cristian Ovalle, PE**

Team Manager, Pipeline Rehab PM Team

Metropolitan Water District of [Southern California](#)

[700 North Alameda Street, Los Angeles CA 90012](#)

(213) 217-5684 mobile: (310) 880-0454

--



**Manuel Perez**

**Chief Street Services Investigator I**

City of Los Angeles | Department of Public Works

Bureau of Street Services | Investigation and Enforcement

[1149 S Broadway 3rd Floor, Suite 350 Los Angeles, CA 90015](#)

C (213) 761-0977 | [manuel.perez@lacity.org](mailto:manuel.perez@lacity.org)

Website: <http://bss.lacity.org/InvestigationAndEnforcement/index.htm>



<https://www.cdph.ca.gov/>

***Need a request?***

Call Service Request (800) 996-2489 or contact <https://myla311.lacity.org>

Department of Transportation - [myladot.lacity.org](http://myladot.lacity.org)

CONFIDENTIALITY NOTICE: This communication with its contents may contain confidential and/or legally privileged information. It is solely for the use of the intended recipient(s). Unauthorized interception, review, use or disclosure is prohibited and may violate applicable laws including the

Electronic Communications Privacy Act. If you are not the intended recipient please contact the sender and destroy all copies of the communication.



**Manuel Perez**

**Chief Street Services Investigator I**

City of Los Angeles | Department of Public Works

Bureau of Street Services | Investigation and Enforcement

1149 S Broadway 3rd Floor, Suite 350 Los Angeles, CA 90015

C (213) 761-0977 | [manuel.perez@lacity.org](mailto:manuel.perez@lacity.org)

Website: <http://bss.lacity.org/InvestigationAndEnforcement/index.htm>



<https://www.cdph.ca.gov/>

***Need a request?***

Call Service Request (800) 996-2489 or contact <https://myla311.lacity.org>

Department of Transportation - [myladot.lacity.org](http://myladot.lacity.org)

CONFIDENTIALITY NOTICE: This communication with its contents may contain confidential and/or legally privileged information. It is solely for the use of the intended recipient(s). Unauthorized interception, review, use or disclosure is prohibited and may violate applicable laws including the

Electronic Communications Privacy Act. If you are not the intended recipient please contact the sender and destroy all copies of the communication.



**Manuel Perez**

**Chief Street Services Investigator I**

City of Los Angeles | Department of Public Works

Bureau of Street Services | Investigation and Enforcement

1149 S Broadway 3rd Floor, Suite 350 Los Angeles, CA 90015

C (213) 761-0977 | [manuel.perez@lacity.org](mailto:manuel.perez@lacity.org)

Website: <http://bss.lacity.org/InvestigationAndEnforcement/index.htm>



<https://www.cdph.ca.gov/>

***Need a request?***

Call Service Request (800) 996-2489 or contact <https://myla311.lacity.org>  
Department of Transportation - [myladot.lacity.org](https://myladot.lacity.org)

CONFIDENTIALITY NOTICE: This communication with its contents may contain confidential and/or legally privileged information. It is solely for the use of the intended recipient(s). Unauthorized interception, review, use or disclosure is prohibited and may violate applicable laws including the

Electronic Communications Privacy Act. If you are not the intended recipient please contact the sender and destroy all copies of the communication.



# Pipeline Relining Project Coming to Your Area



THE METROPOLITAN WATER DISTRICT  
OF SOUTHERN CALIFORNIA

As part of our commitment to enhancing water infrastructure in the region, The Metropolitan Water District of Southern California is working diligently on the Second Lower Feeder Pipeline Improvement Project.

## WHAT TO EXPECT DURING CONSTRUCTION

Water supplies will not be affected, however residents and businesses can expect the following during construction:

- Temporary traffic delays
- Lane restrictions
- Potential noise due to construction, excavation, ventilation, and equipment

We apologize for any inconvenience and appreciate your understanding as we work to ensure future water reliability for the community.

Construction is anticipated to begin mid-November, 2023 and last through June 2024. Work will occur 24 hours a day, 7 days a week in order to put the pipeline back in service as quickly as possible.

All nighttime work will occur underground.

Como parte de nuestro compromiso de mejorar la infraestructura hídrica en la región, el Metropolitan Water District of Southern California está trabajando con diligencia en el proyecto de rehabilitación del Second Lower Feeder.

## QUÉ ESPERAR DURANTE LA CONSTRUCCIÓN

El suministro de agua no se verá afectado, sin embargo, los residentes y las empresas pueden esperar lo siguiente durante la construcción:

- Retrasos temporales de tráfico
- Restricciones de carril
- Posible ruido debido a la construcción, excavación, ventilación y otros equipos de construcción

Nos disculpamos por cualquier inconveniente y agradecemos su comprensión mientras trabajamos para garantizar la confiabilidad futura del agua para la comunidad.

Se anticipa que la construcción comience a mediados de noviembre de 2023 y dure hasta junio de 2024. El trabajo ocurrirá las 24 horas del día, los 7 días de la semana para volver a poner la tubería en servicio lo más rápido posible.

Todo el trabajo nocturno ocurrirá bajo tierra.

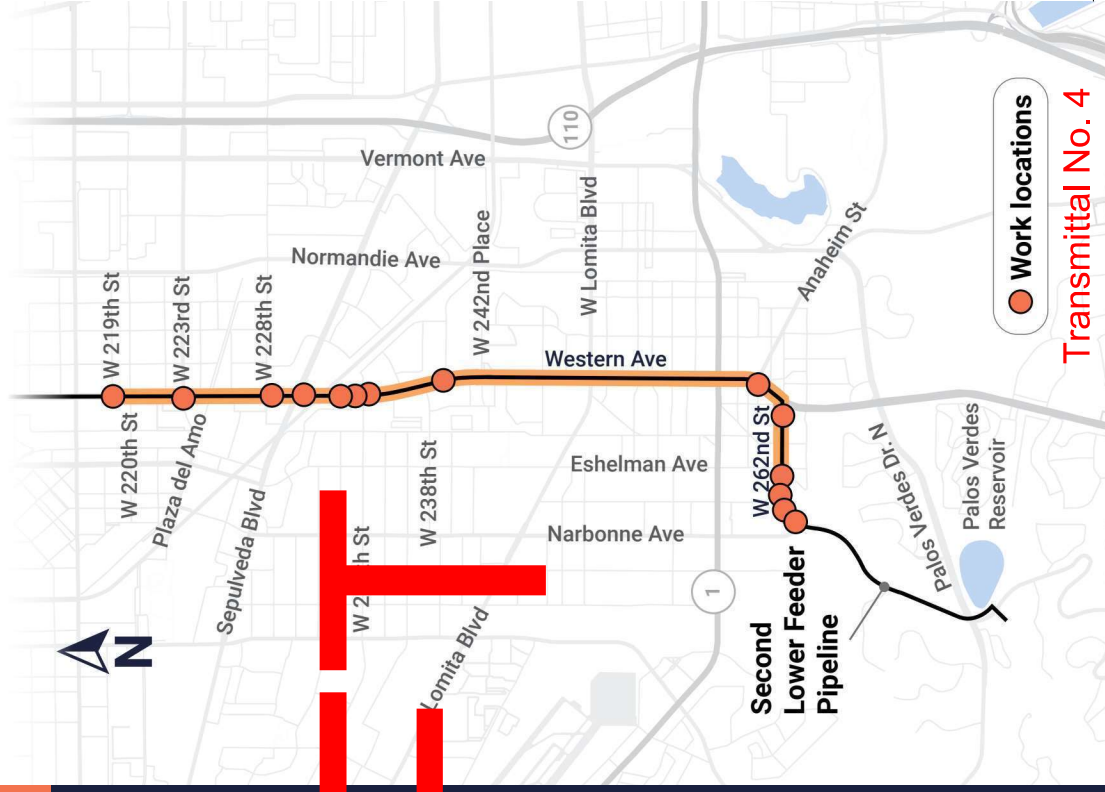

Transmittal No. 4

BPW-2024-0615



THE METROPOLITAN WATER DISTRICT  
OF SOUTHERN CALIFORNIA

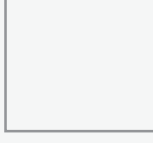

## CONTACT US *Contáctenos*

If you have any questions or concerns, our team is here to assist you!

**Ivonne Castillo** (213) 217-6809  
**Lizeth Martinez** (213) 217-5776

## FOR MORE INFORMATION

**Metropolitan Water District:**  
mwdh2o.com

CommunityRelations@mwdh2o.com

**DRAFT**

## ABOUT US

The mission of The Metropolitan Water District of Southern California is to provide its service area with adequate and reliable supplies of high-quality water to meet present and future needs in an environmentally and economically responsible way.

## SOBRE NOSOTROS

La misión de Metropolitan Water District of Southern California es brindar a su área de servicio suministros de agua adecuados y confiables de alta calidad para satisfacer las necesidades presentes y futuras de una manera ambiental y económicamente responsable.



@mwdh2o



THE METROPOLITAN WATER DISTRICT  
OF SOUTHERN CALIFORNIA

# Proyecto de Rehabilitación del Second Lower Feeder

## Sobre el proyecto

El Second Lower Feeder del Metropolitan Water District es una tubería clave en nuestro sistema de suministro de agua regional. La tubería entrega agua potable tratada desde la planta Robert B. Diemer en la ciudad de Yorba Linda hasta la presa de Palos Verdes en Rolling Hills Estates. Originalmente construida en 1967, la tubería cilíndrica de concreto pretensado necesita ser revestida con acero para garantizar la confiabilidad del agua en el futuro. El área de construcción afectará el tráfico a lo largo de Western Ave. y las calles que se cruzan entre 262nd St. en Lomita y 219th St. en las ciudades de Torrance y Los Ángeles.

## Que esperar

Las tripulaciones y el equipo comenzarán a movilizarse en noviembre de 2023. El trabajo está aprobado para llevarse a cabo las 24 horas del día, según sea necesario.

## Para más información

Metropolitan Water District of  
Southern California:  
mwdh2o.com

Email:  
CommunityRelations@mwdh2o.com

## Contactos para este proyecto

Lizeth Martinez  
(626) 827-0614

Ivon  
(213) 7-6809

# DRAFT

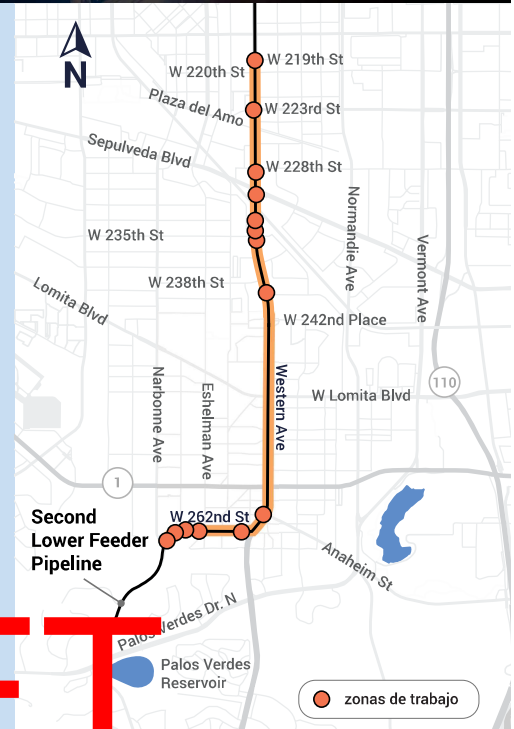

## Sobre nosotros

### Quiénes somos

La misión de Metropolitan Water District of Southern California es brindar a su área de servicio suministros de agua adecuados y confiables de alta calidad para satisfacer las necesidades presentes y futuras de una manera ambiental y económicamente responsable.

### A quién servimos

Metropolitan Water District of Southern California es una cooperativa establecida por el estado que cuenta con 26 agencias miembros (ciudades y agencias públicas de agua) y abastece a 19 millones de personas en seis condados.

### Lo que hacemos

Metropolitan importa agua del río Colorado y del norte de California para complementar los suministros locales y ayuda a sus miembros a desarrollar programas de conservación, reciclaje y almacenamiento del agua, así como otros programas de administración de los recursos.

## Preguntas frecuentes

### P. ¿Cuáles serán los beneficios del proyecto?

R. El proyecto brinda confiabilidad continua del agua con una buena relación coste-eficacia para el sistema de distribución de Metropolitan y reduce el riesgo de reparaciones de emergencia inesperadas.

### P. ¿Cuánto tiempo llevará este proyecto?

R. Este proyecto ocurrirá en dos fases. La primera fase será de agosto de 2023 a junio de 2024. La segunda fase será de noviembre de 2024 a junio de 2025. Los proyectos grandes pueden tener problemas imprevistos. Sin embargo, debido a que se trata de una tubería de agua importante, tenemos un compromiso con nuestras agencias miembro para que la tubería vuelva a funcionar como se esperaba. Se toman todas las medidas para completar el proyecto a tiempo.

### P. ¿Por qué necesita trabajar las 24 horas del día, los 7 días de la semana?

R. Es necesario trabajar las 24 horas para revestir esta tubería y completar el proyecto de manera eficiente. Nuestro objetivo es reanudar las condiciones operativas normales para que podamos garantizar un suministro confiable de agua a nuestras agencias miembro.

### P. ¿Este proyecto afectará mi servicio de agua?

R. No. Su proveedor local de agua seguirá entregando agua sin interrupciones en el servicio.

### P. ¿Voy a escuchar ruido de construcción toda la noche?

R. La mayoría, si no todo, del trabajo se realizará bajo tierra dentro de la tubería, minimizando el ruido. Es posible que oiga el ruido de los generadores necesarios para operar el sistema de ventilación en la tubería.

### P. ¿Cómo afectará esto al tráfico?

R. Puede haber cierres de carriles y restricciones de estacionamiento. Revise el mapa al otro lado de este folleto para conocer los impactos cerca de usted.



## Major Pipeline Rehabilitation Project Coming to Your Area

## Importante proyecto de rehabilitación de tubería llegará a su área



@mwdh2o