

ADOPTED BY THE BOARD
PUBLIC WORKS OF THE CITY
of Los Angeles California

Department of Public Works

OCT 02 2024

Bureau of Engineering
Bureau of Contract Administration
Joint Report No.2

Executive Officer
Board of Public Works

October 2, 2024

CD Nos. 3, 4, 6, 7, 8, 9, 11, 12, and 15

CONTRACT AWARD TO INTERNATIONAL LINE BUILDERS, INC., DBA ILB ELECTRIC, FOR THE HIGHWAY SAFETY IMPROVEMENT PROGRAM (HSIP) 8 LEFT TURN SIGNAL MODIFICATION AND MEDIAN ISLANDS (13 LOCATIONS), FEDERAL PROJECT I.D. NO. HSIPL-5006(868) (WORK ORDER NO. E1908343)

RECOMMENDING THE BOARD OF PUBLIC WORKS (BOARD):

1. DECLARE International Line Builders, Inc., dba ILB Electric (ILB), sole bidder, to be the lowest responsive, responsible bidder, and AWARD ILB a contract for the HSIP 8 Left Turn Signal Modification and Median Islands (13 Locations), Federal Project I.D. No. HSIPL-5006(868) (Project) for \$6,413,893.
2. AUTHORIZE the President or two members of the Board to execute the contract after approval as-to-form has been obtained from the City Attorney.

TRANSMITTAL

Summary of bids received on May 8, 2024.

DISCUSSION

Background

The Project will modify traffic signals at 13 different intersections throughout the City of Los Angeles (City) by installing protected left-turn phasing operations and accessible pedestrian signals (APS) and pushbuttons, including upgrading curb ramps and street lighting and reconstructing/resurfacing street pavement. The Project locations are at the intersections of: (1) Alla Road, Concert Park Drive, and Jefferson Boulevard; (2) Balboa Boulevard and Parthenia Street; (3) El Medio Avenue and Sunset Boulevard; (4) Foothill Boulevard and Osborne Street; (5) Plummer Street and Tampa Avenue; (6) Tujunga Avenue and Ventura Boulevard; (7) 62nd Street and Western Avenue; (8) Compton Avenue and Imperial Highway; (9) Florence Avenue and Van Ness Avenue; (10) Gage Avenue and Main Street; (11) Lassen Street and Sepulveda Boulevard; (12) Lindley Avenue and Sherman Way; and (13) Tampa Avenue and Victory Boulevard (Figure No. 1).



Figure No. 1: Project map and locations

The typical scope of work for each of the 13 intersections includes installing signal poles and foundations, new conduits, pull boxes, mast arms, signal heads, pedestrian heads, detector loops, and street lighting. In addition, the curb ramps and sidewalk will be reconstructed and upgraded to current accessibility standards. As an example, the scope of work for the intersection of Lindley Avenue and Sherman Way is shown in Figure No. 2. The contract duration is 455 calendar days.

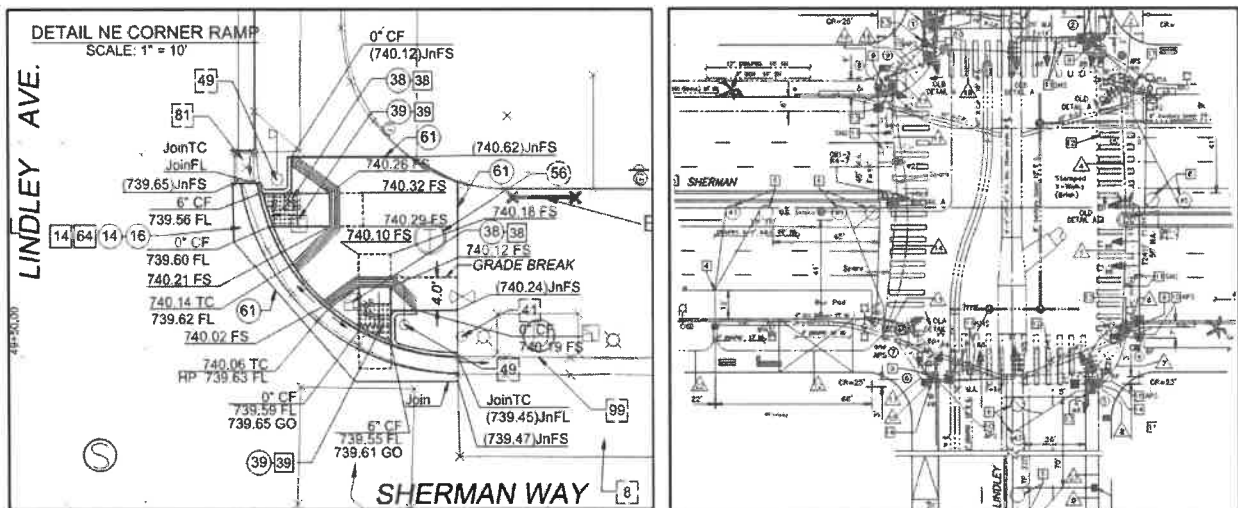

Figure No. 2: Typical Project scope of work. Curb ramp and sidewalk (left). Traffic signal and striping (right). Location at Lindley Avenue and Sherman Way.

Department of Public Works
Bureau of Engineering
Bureau of Contract Administration
Joint Report No.2

October 2, 2024
Page 3

The Project has been reviewed for environmental considerations. It was determined to be categorically exempt pursuant to the provisions of the California Environmental Quality Act (CEQA) of 1970 under Article III of the City's CEQA Guidelines. It was determined that the Project complies with the provisions of the National Environmental Policy Act under categorical exclusion.

Bid Review

The sole bid received (Transmittal) compared with the City Engineer's estimate of \$4,712,911 is:

Disadvantaged Business Enterprise Program Outreach Codes:

DBE = Disadvantaged Business Enterprise

OBE = Other Business Enterprise

<u>Bid No.</u>	<u>Contractor's Name</u>	<u>Bid Amount</u>	<u>% High/Low</u>	<u>% Pledged</u>	
				<u>DBE</u>	<u>OBE</u>
Sole Bid	ILB (OBE)	\$6,413,893.00	36.09% High	22.27%	17.13 %

Staff believes the scale and complexity of work in combination with adding available additional subcontractors for the DBE participation to this Project is the reason for the low bidder participation and bid amount being higher than the City Engineer's estimate. After evaluating the bid, staff believes that the sole bid is reasonable. Staff also believes that re-advertising the Project will not likely attract additional or lower bidders. The contract may be awarded to ILB, sole bidder, subject to verification of all other bidding requirements.

DBE Program

This Project is federally-funded and is subject to the City's DBE Program in accordance with regulations of the U.S. Department of Transportation, 49 Code of Federal Regulations, Part 26 and the California Department of Transportation's (Caltrans) DBE Program. The Race-Conscious DBE participation level was calculated using the dollar amounts of the DBE-certified subcontractors. Subcontractors not certified as DBE were considered OBE. Caltrans requires that staff calculate the DBE pledged participation levels based on the information provided on the bidder's Exhibit 15-G.

The Project was advertised with a DBE goal of 21.00 percent. The Office of Contract Compliance, based on the review of the documents submitted by ILB, reported that the contractor pledged a DBE commitment of 22.27 percent and an OBE participation level of 17.13 percent. Under the Caltrans Race-Conscious DBE Program, the bidder must either meet the DBE goal or submit adequate DBE Good Faith Efforts (GFE) documentation. ILB met the DBE goal and therefore, was not required to submit DBE GFE documentation.

ILB pledged the following DBE/OBE subcontractor utilization:

Gender/Ethnicity Codes:

AA = African American
 APA = Asian Pacific American
 NA = Native American
 M = Male

HA = Hispanic American
 SAA = Subcontinent Asian American
 C = Caucasian
 F = Female

Subcontractors	DBE/ OBE	Gender/ Ethnicity	% of Bid	Dollar Amount
Her-Con Construction Services, Inc.	DBE	M/HA	22.27%	\$1,428,582.00
Superior Pavement Markings, Inc.	OBE		3.26%	\$ 209,129.00
Smithson Electric, Inc.	OBE		1.20%	\$ 77,180.00
Rexel USA, Inc. ¹	OBE		3.01%	\$ 192,960.00
SWARCO McCain, Inc. ²	OBE		9.66%	\$ 619,325.00

¹This firm is a regular dealer; therefore, its bid-listed amount of \$321,600.00 was credited at 60 percent.

²This firm is a manufacturer; therefore, its bid-listed amount of \$619,325.00 was credited at 100 percent.

Compliance with the City's Non-Discrimination Policies

ILB shall comply with the Federal and City Affirmative Action, Non-Discrimination, and Equal Employment Practices Provisions, Equal Benefits Ordinance, Contractor's Use of Criminal History for Consideration of Employment Applications Ordinance, Living Wage Ordinance, Worker Retention Ordinance, First Source Hiring Ordinance, Slavery Disclosure Ordinance, and Disclosure of Border Wall Contracting Ordinance requirements of the bid.

Previous Work Record

ILB has worked on several contracts issued by the Board. No significant or unresolved problems in inspection, contract compliance, or bidder responsibility have been experienced by the Bureau of Contract Administration (BCA).

The following table summarizes the previous DBE /OBE participation levels pledged by ILB in the past five years.

DBE/OBE Pledged Utilization Table (Race-Conscious DBE Program)			
No. of Contracts	Total \$ Value of Contracts	Pledged DBE \$ Amount	Pledged OBE \$ Amount
		Total DBE (%)	Total OBE (%)
		\$280,316.76	\$114,000.00
4	\$3,764,095	7.45%	3.03%

Contractor Performance Evaluation Ordinance

In accordance with Article 13, Chapter 1, Division 10, of the Los Angeles Administrative Code (L.A.A.C.), the Project Manager and the City Inspector for this construction contract shall submit Contractor Performance Evaluation Reports to the BCA (Department of Public Works) upon completion of this contract.

October 2, 2024

Page 5

Peak Hour Construction and Right-of-Way Obstruction Regulations

All contractors must comply with the requirements specified in the Los Angeles Municipal Code Section 62.61 related to peak hour traffic restrictions unless an exemption from the Peak Traffic Hours Prohibition is approved.

Contractor Responsibility Ordinance

All contractors participating in this program are subject to compliance with the requirements specified in the City Contractor Responsibility Ordinance No. 173677 (Article 14, Chapter 1, Division 10, L.A.A.C.). Failure to comply with all the requirements specified in the ordinance may render this bidder's contract subject to termination pursuant to the conditions expressed therein.

Bid Bond Extension

ILB was requested to extend their Bid Bond which expired on August 9, 2024. ILB has agreed to extend their Bid Bond until October 4, 2024.

Conclusion

In view of the above findings, staff recommends that the Board declare ILB, sole bidder, to be the lowest responsive, responsible bidder, and award ILB the contract for this project.

STATUS OF FUNDING

The project is federally funded by the HSIP Cycle 8 Grant, State of California's Coronavirus Response and Relief Supplemental Appropriations Act Grant, and City local match funds. The Los Angeles Department of Transportation (LADOT) Transportation Grant Funds, Fund No. 655, Department No. 94, Appropriation Unit No. 94PT89, provides the front funds.

Additional funding comes from the Capital and Technology Improvement Expenditure Program by the Senate Bill 1 funds, Fund No. 59V, Department No. 50, Appropriation Unit No. 50AZCI.

The Director of the Office of Accounting and the Assistant General Manager of the LADOT has identified and verified the following funding sources currently available for this project:

Fund No.	Appropriation Unit No.	Budget Fiscal Year	Contract	Contingencies	Total
655	94PT89	2018	\$5,245,314.01	\$ 0.00	\$5,245,314.01
59V	50AZCI	2025	\$1,168,578.99	\$731,390.00	\$1,899,968.99
Total			\$6,413,893.00	\$731,390.00	\$7,145,283.00

The contract contains a "Financial Liability Clause" which states that "the City's liability under this contract shall only be to the extent of the present City appropriation to fund the contract. However, if the City shall appropriate funds for any succeeding years, the City's liability shall be extended to the extent of such appropriation, subject to the terms and conditions of the contract."

liability shall be extended to the extent of such appropriation, subject to the terms and conditions of the contract."

(NM AV RMK JF)

Report reviewed by:

BOE (ADM and SID)

Report prepared by:

Project Award and Control Division

Arsen Voskerchyan, PE
Division Engineer
Phone No. (213) 485-4516

Compliance review performed
and approved by:

Ian Monteilh (Sep 10, 2024 07:12 PDT)

Lynda McGlinchey, Program Manager II
Office of Contract Compliance
Bureau of Contract Administration

Respectfully submitted,

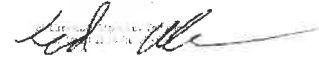



Ted Allen, PE
City Engineer
Bureau of Engineering



John L. Reamer, Jr.
Inspector of Public Works
Bureau of Contract Administration

Statement as to funds approved by:

Miguel De La Peña, Director
Office of Accounting
Fund Ref. 59V/50AZCI/\$1,899,968.99
Date: 9/10/2024

Kevin Minne, Assistant General Manager
Los Angeles Department of Transportation
Fund Ref. 655/94PT89/\$5,245,314.01
Date: 09/10/2024

AV/AM/08-2024-0116_PAC.pnc

Questions regarding this
report may be referred to:
Ava Majidi, Project Manager
Phone No. (213) 485-4589
Email: ava.majidi@lacity.org

Bid Results

City of Los Angeles - Department of Public Works - Bureau of Engineering
Highway Safety Improvement Program (HSIP) 8 Left Turn Signal
Modification and Median Islands (13 Locations) Federal I.D. No.
HSIPL-5006(868)



W.O. E1908343

Bid Date: May 8, 2024

Council District: 3,4,6,7,8,9,11,12,15

Bids Received: 1

SUMMARY			
COMPANY	BID AMOUNT	PERCENTAGE	HIGH/LOW
CITY ENGINEER'S ESTIMATE			
1 International Line Builders Inc., dba ILB Electric	\$ 4,712,911.00	36.09%	HIGH
AVERAGE (MEAN)	\$ 6,413,893.00	36.09%	HIGH
MEDIAN	\$ 6,413,893.00		